

All dimensions to be checked on site. Figured dimensions take preference over scaled dimensions. Any errors or discrepancies to be reported to the Architects. This drawing may not be edited or modified by the recipient.

Copyright and ownership of this drawing is vested in RKD Architects, whose prior written consent is required for its use, reproduction or for publication to any third party. All rights reserved by the law of copyright and by international copyright conventions are reserved to RKD Architects and may be protected by court proceedings for damages and/or injunctions and costs. RKD Architects' Quality Management Systems are certified to ISO 9001:2015.

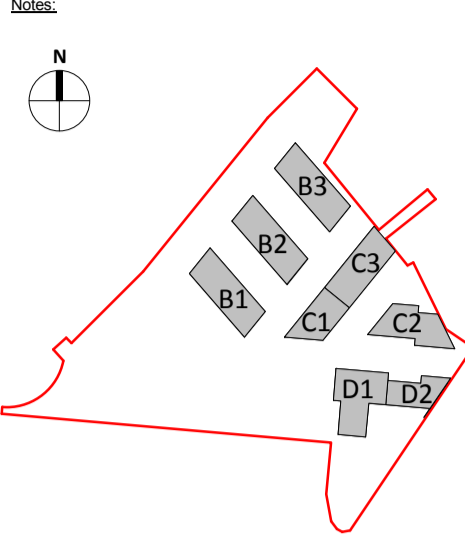

— SITE BOUNDARY

Notes:
All coordinates relate to the Irish Transverse Mercator (ITM) and are displayed in meters (m). All levels relate to Malin Head datum. All dimensions are given in millimeters (mm).

| USE |
|--------------------------------|
| STUDIO APARTMENT |
| 1 BED APARTMENT |
| 2 BED APARTMENT |
| 3 BED APARTMENT |
| INTERNAL RESIDENTIAL AMENITIES |
| RETAIL |
| COMMUNITY |
| HOTEL |
| OFFICE |
| ANCILLARY USE |

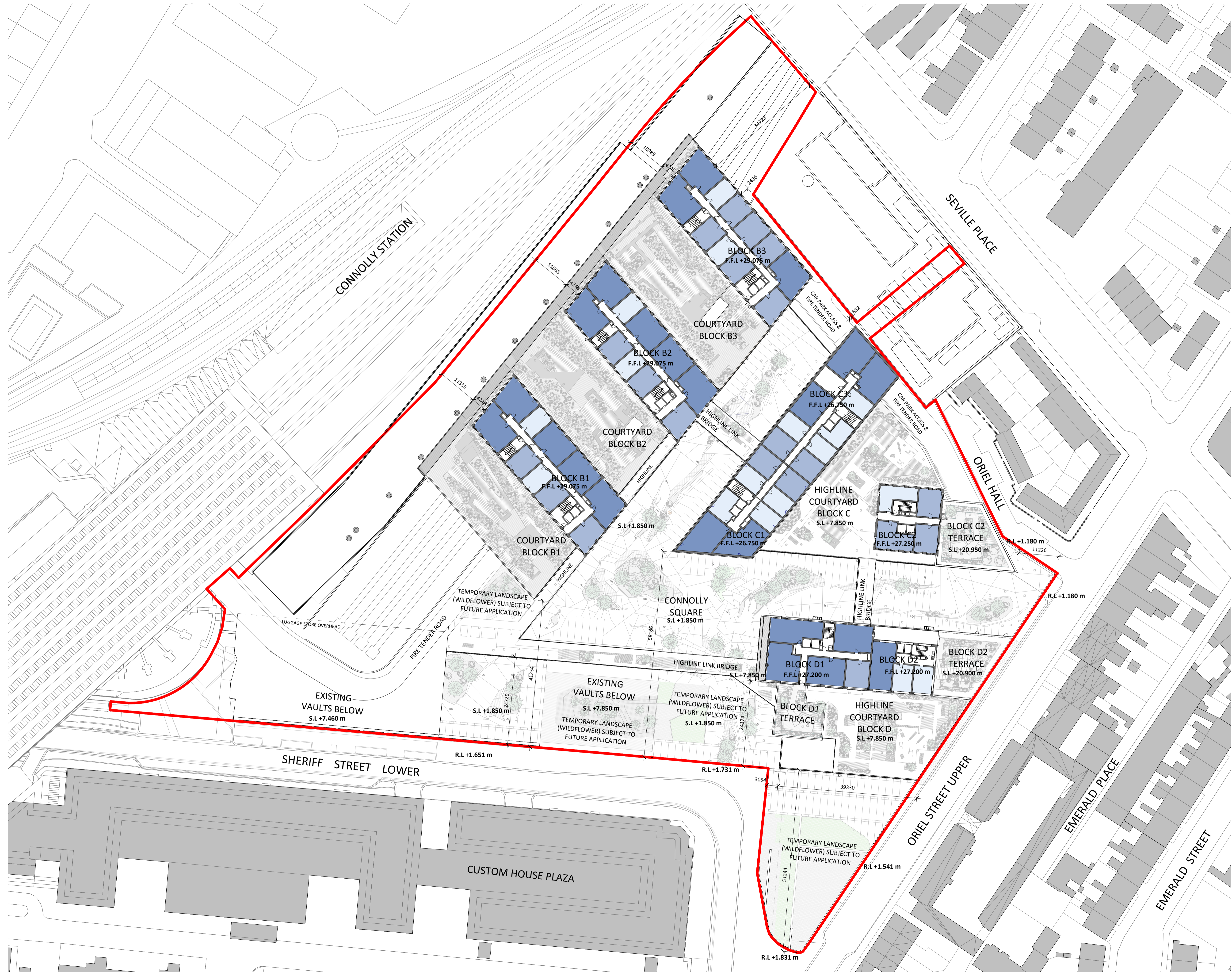

1 SITE LAYOUT PLAN - LEVEL 07
1 : 500

| Rev. | Date | Description |
|------|----------|--|
| A | OCT 2019 | Issued for Planning Application Submission |

STATUS: **PLANNING**
 PROJECT: THE CONNOLLY QUARTER
 PROJECT ADDRESS: Lands to the Rear of Connolly Station, Dublin 1
 DWG TITLE: SITE LAYOUT PLAN LEVEL 07
 DWG NO: 18135-RKD-00-07-DR-A-1011

| REV. | PROJECT NO. | SCALE |
|------|-------------|---------|
| A | 18135 | 1 : 500 |

DATE: JUN 2019 DRN: CNAB CHK: CS

RKD
 59 Northumberland Rd
 Ballsbridge, Dublin 4
 D04 W9P6, Ireland

+353 1 666 1006
 info@rkd.ie
 rkd.ie

ARROW
 Name: Farnagade 13, st th
 DK-1364 Copenhagen K
 Denmark

+45 4226 2860
 info@arrowarchitects.com
 www.arrowarchitects.com